



(22) Date de dépôt/Filing Date: 2007/07/04

(41) Mise à la disp. pub./Open to Public Insp.: 2009/01/04

(45) Date de délivrance/Issue Date: 2012/01/03

(51) Cl.Int./Int.Cl. *F16B 1/00* (2006.01),  
*E04H 4/08* (2006.01), *F16B 5/00* (2006.01),  
*F16B 5/02* (2006.01)

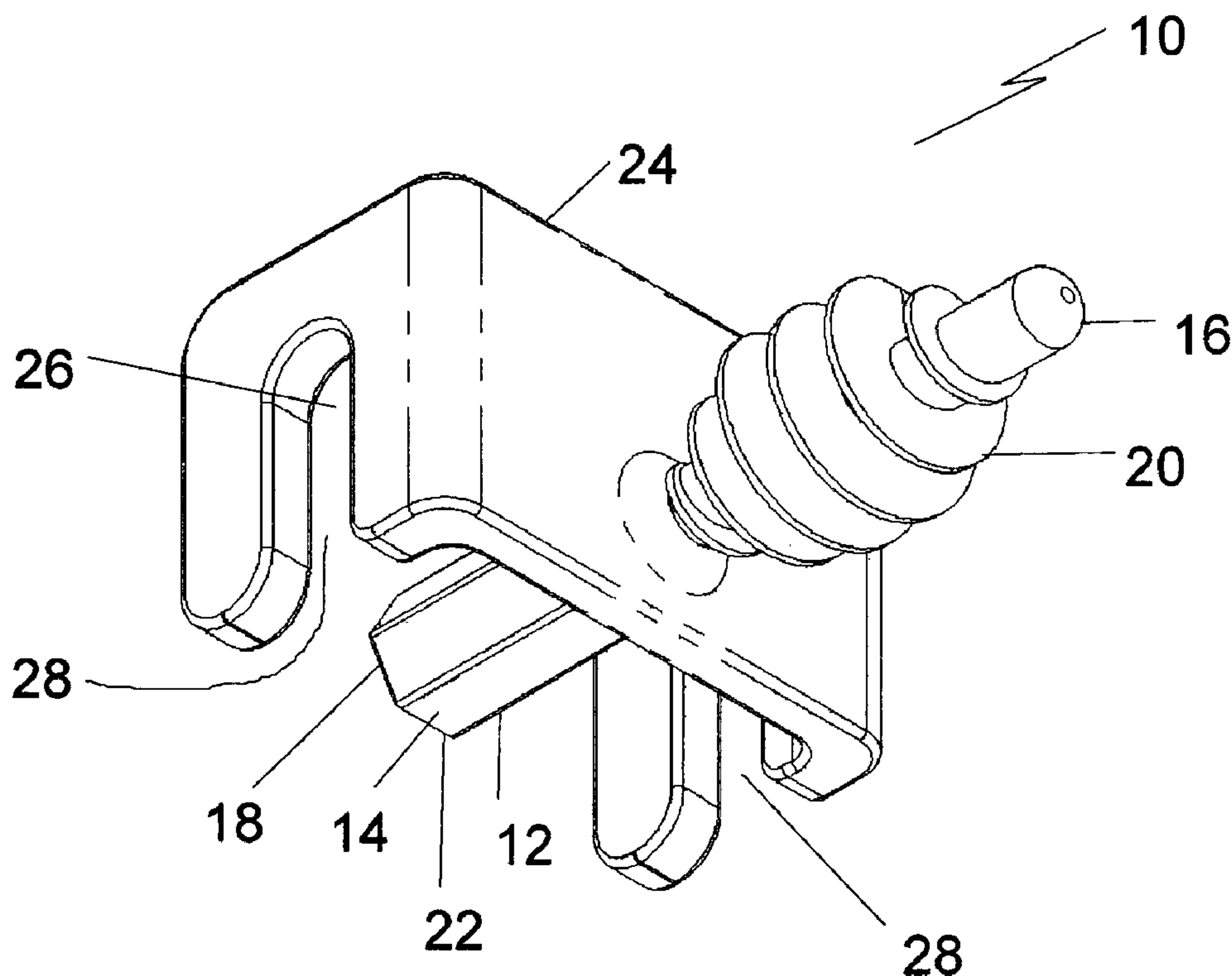
(72) Inventeurs/Inventors:  
MILLS, J. ANDREW, CA;  
MACQUEEN, JASON J. R., CA

(73) Propriétaire/Owner:  
LAYFIELD GEOSYNTHETICS & INDUSTRIAL FABRICS  
LTD., CA

(74) Agent: WOODRUFF, NATHAN V.

(54) Titre : PROCEDE ET EQUIPEMENT DE RACCORDEMENT DE COUVERCLES FLOTTANTS

(54) Title: METHOD OF AND APPARATUS FOR CONNECTING FLOATING COVERS



(57) Abrégé/Abstract:

An apparatus for connecting pond covers, which includes a shaft having an exterior surface, a first end and a second end. An engagement profile is positioned on the exterior surface at a first end of the shaft. A cable guide is positioned in an intermediate position between the first end and the second end of the shaft, the cable guide being oriented transversely to the shaft. A cable is prevented from removal from the cable guide by the second end of the shaft.

## ABSTRACT OF THE DISCLOSURE

An apparatus for connecting pond covers, which includes a shaft having an exterior surface, a first end and a second end. An engagement profile is positioned on the exterior surface at a first end of the shaft. A cable guide is positioned in an intermediate position  
5 between the first end and the second end of the shaft, the cable guide being oriented transversely to the shaft. A cable is prevented from removal from the cable guide by the second end of the shaft.

## TITLE:

Method of and apparatus for connecting floating covers.

## FIELD

5           The present invention relates to a method and associated apparatus which can be used to connect floating covers.

## BACKGROUND

10           United States Patent 5,400,549 (Morgan) discloses a pond cover which consists of a plurality of cover panel units connected together with cable connectors.

## SUMMARY

15           According to one aspect there is provided an apparatus for connecting floating covers, which includes a shaft having an exterior surface, a first end and a second end. An engagement profile is positioned on the exterior surface at a first end of the shaft. A cable guide is positioned in an intermediate position between the first end and the second end of the shaft, the cable guide being oriented transversely to the shaft. A cable is prevented from removal from the cable guide by the second end of the shaft.

20           According to another aspect there is provided a method of connecting floating covers. A first step involves providing two floating covers having grommets positioned along a peripheral edge which define floating cover attachment openings, along with the above described apparatus for connecting floating covers. A second step involves overlapping the peripheral edge of the two floating covers with the floating cover attachment openings of the two floating covers axially aligned. A third step involves inserting the first end of the shaft of one of the apparatus for connecting floating covers into one of the floating cover attachment openings, with the engagement profile preventing removal of the shaft from the floating cover attachment openings. (Note that these covers could be installed on ponds and as tank covers).

## 30   BRIEF DESCRIPTION OF THE DRAWINGS

          These and other features will become more apparent from the following description in which reference is made to the appended drawings, the drawings are for the purpose of illustration only and are not intended to in any way limit the scope of the invention to the

particular embodiment or embodiments shown, wherein:

**FIG. 1** is a perspective view of an apparatus for connecting floating covers.

**FIG. 2** is a front elevation view of the apparatus for connecting floating covers illustrated in **FIG. 1**.

5 **FIG. 3** is a left side elevation view of the apparatus for connecting floating covers illustrated in **FIG. 1**.

**FIG. 4** is a right side elevation view of the apparatus for connecting floating covers illustrated in **FIG. 1**.

10 **FIG. 5** is a rear elevation view of the apparatus for connecting floating covers illustrated in **FIG. 1**.

**FIG. 6** is a top plan view of the apparatus for connecting floating covers illustrated in **FIG. 1**.

**FIG. 7** is a bottom plan view of the apparatus for connecting floating covers illustrated in **FIG. 1**.

15 **FIG. 8** is a side elevation view, in section, of two floating covers connected with one of the apparatus for connecting floating covers illustrated in **FIG. 1**.

**FIG. 9** is a side elevation view of the apparatus for connecting floating covers illustrated in **FIG. 1**, with an alternative form of engagement profile.

20 **FIG. 10** is a top perspective view of floating covers connected with the apparatus for connecting floating covers illustrated in **FIG. 1**.

#### DETAILED DESCRIPTION

25 An apparatus for connecting floating covers generally identified by reference numeral 10, will now be described with reference to **FIG. 1** through **FIG. 10**.

#### Structure and Relationship of Parts:

30 Referring to **FIG. 1**, apparatus 10 has a shaft 12 having an exterior surface 14, a first end 16 and a second end 18. Referring to **FIG. 2** and **FIG. 3**, an engagement profile 20, in the form of helical thread, is positioned on the exterior surface 14 at first end 16 of shaft. Referring to **FIG. 1** and **FIG. 5**, a hexagonal head rotational drive adaptor 22 is positioned at second end 18 of shaft 12. Referring to **FIG. 1** and **FIG. 7**, a cable guide 24 is positioned in



an intermediate position between first end 16 and second end 18 of shaft 12. Cable guide 24 is oriented transversely to shaft 12 and has a cable retention channel 26 and a cable access slot 28. A cable may be retained in cable retention channel 26 by the positioning of second end 18 of shaft 12 between cable retention channel 26 and cable access slot 28, this is illustrated in **FIG. 10** in relation to cable 30.

#### Operation:

Referring to **FIG. 8**, a method of connecting floating covers 32 is illustrated. Floating covers 32 may be used as covers for ponds, pools, tanks, etc. While the description below refers to pond covers, it will be understood that it may also be used in other situations. At least two pond covers 32 are required. Each pond cover 32 has holes 34 positioned along a peripheral edge 36. Holes 34 define pond cover attachment openings 38 and provide for apparatus 10 to connect the pond covers 32. Peripheral edge 36 of two pond covers 32 are overlapped with the pond cover attachment openings 38 axially aligned. To connect pond covers 32 insert first end 16 of shaft 12 of apparatus 10 into one of the pond cover attachment openings 38. Engagement profile 20 engages with holes 34 to ensure that pond covers 32 remained aligned and connected at peripheral edge 36. This enables several pond covers 32 to be connected to create a pond cover sufficient to cover the size of pond.

Referring to **FIG. 4** and **FIG. 8**, as engagement profile 20 is helical, a power drill (not shown) is attached to rotational drive adaptor 22 which is positioned at second end 18 of shaft 12, and can be seen in **FIG. 5**. The power drill provides the means for engagement profile 20 and holes 34 to interact and secure the two pond covers 32 together. Referring to **FIG. 10**, cable 30 is secured in cable guide 24 at second end 18 of shaft 12.

#### Advantages:

The use of the above described method allows the pool covers to be rapidly connected. More importantly, portions of the pool covers can be just as rapidly disconnected when access is required to perform servicing. With the prior art, the separation of the pond covers to enable servicing to be performed and the reconnection of the pond covers after servicing has proven to be a major undertaking.

In addition, current cover fastening methods require at least some access to both sides of the cover panel to install or removed the panels, this can be difficult due to panel size (a typical size may be 8' x 48'), or panel location, if floating on a liquid surface. However, apparatus can be fully installed or removed from a single side of the cover (typically the dry  
5 side).

Variations:

Although apparatus 10 is shown with a helical engagement profile 20 that works with  
10 rotational drive adaptor 22 in **FIG. 1** through **8**, it will be appreciated that other engagement profiles could be made to work. There are too many alternative engagements to illustrate them all. Referring to **FIG. 9**, another viable engagement profile 20 could consist of a series of parallel spaced ridges.

15 In this patent document, the word "comprising" is used in its non-limiting sense to mean that items following the word are included, but items not specifically mentioned are not excluded. A reference to an element by the indefinite article "a" does not exclude the possibility that more than one of the element is present, unless the context clearly requires that there be one and only one of the elements.

20

It will be apparent to one skilled in the art that modifications may be made to the illustrated embodiments without departing from scope of the Claims.

**What is Claimed is:****1. An apparatus for connecting pond covers, comprising:**

a shaft having an exterior surface, a first end, and a second end;

an engagement profile positioned on the exterior surface at the first end of the shaft;

a cable guide positioned in an intermediate position between the first end and the second end of the shaft, the cable guide being oriented transversely to the shaft, the cable guide having a cable retention channel and a cable access slot, a cable being retained in the cable retention channel by the positioning of the second end of the shaft between the cable retention channel and the cable access slot.

**2. The apparatus of Claim 1, wherein the engagement profile is a helical thread.****3. The apparatus of Claim 2, wherein a rotational drive adaptor is positioned at the second end of the shaft.****4. The apparatus of Claim 1, wherein the engagement profile is a series of parallel spaced ridges.****5. The apparatus of Claim 3, wherein the rotational drive adaptor is a polygonal drive head.****6. The apparatus of Claim 5, wherein the rotational drive adaptor is a hexagonal drive head.****7. An apparatus for connecting pond covers, comprising:**

a shaft having an exterior surface, a first end, and a second end;

an engagement profile in the form of helical thread positioned on the exterior surface at the first end of the shaft;

a hexagonal head rotational drive adaptor positioned at the second end of the shaft;

a cable guide positioned in an intermediate position between the first end and the second end of the shaft, the cable guide being oriented transversely to the shaft, the cable guide having a cable retention channel and a cable access slot, a cable being retained in the cable retention



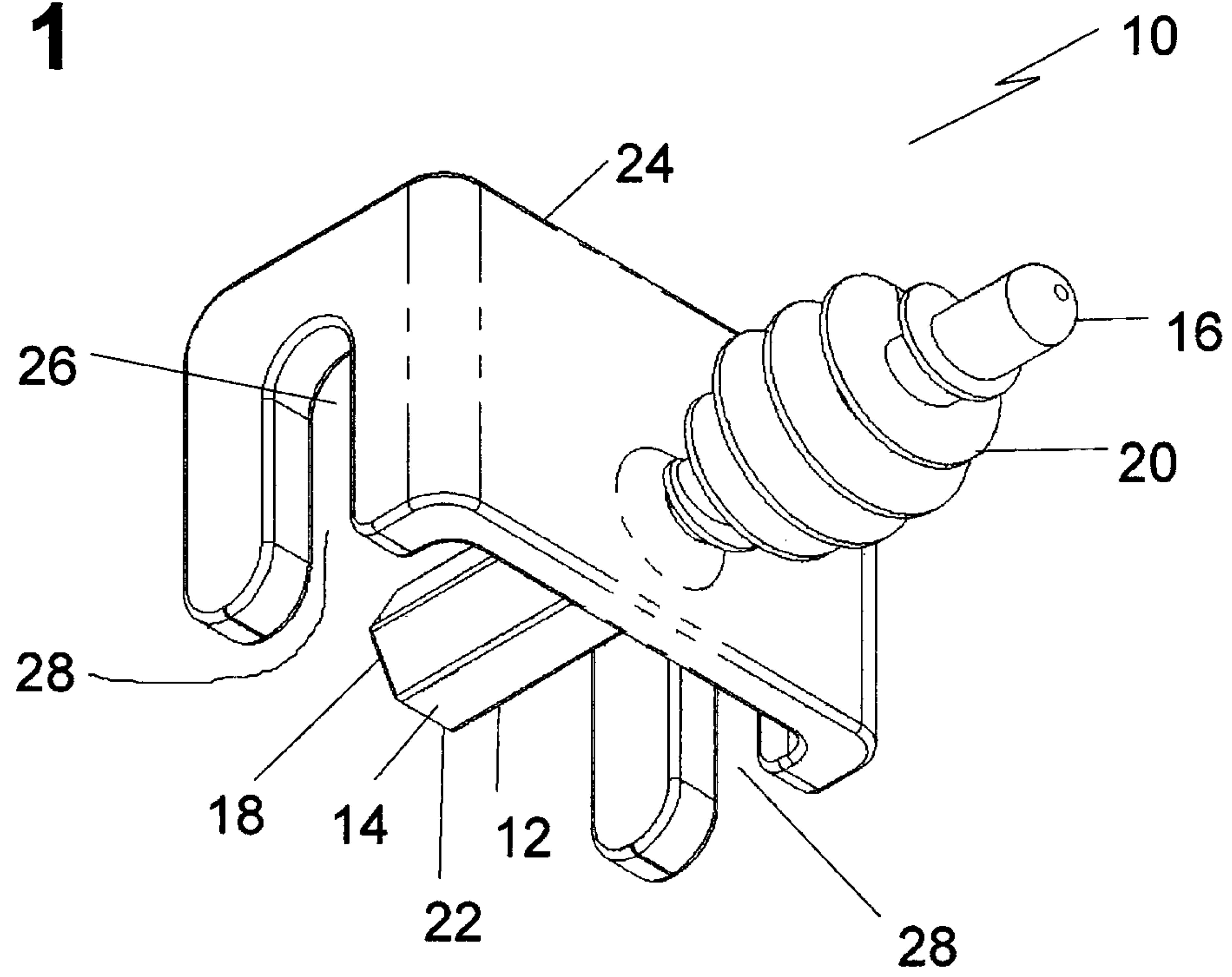
channel by the positioning of the second end of the shaft between the cable retention channel and the cable access slot.

8. A method of connecting pond covers, comprising:

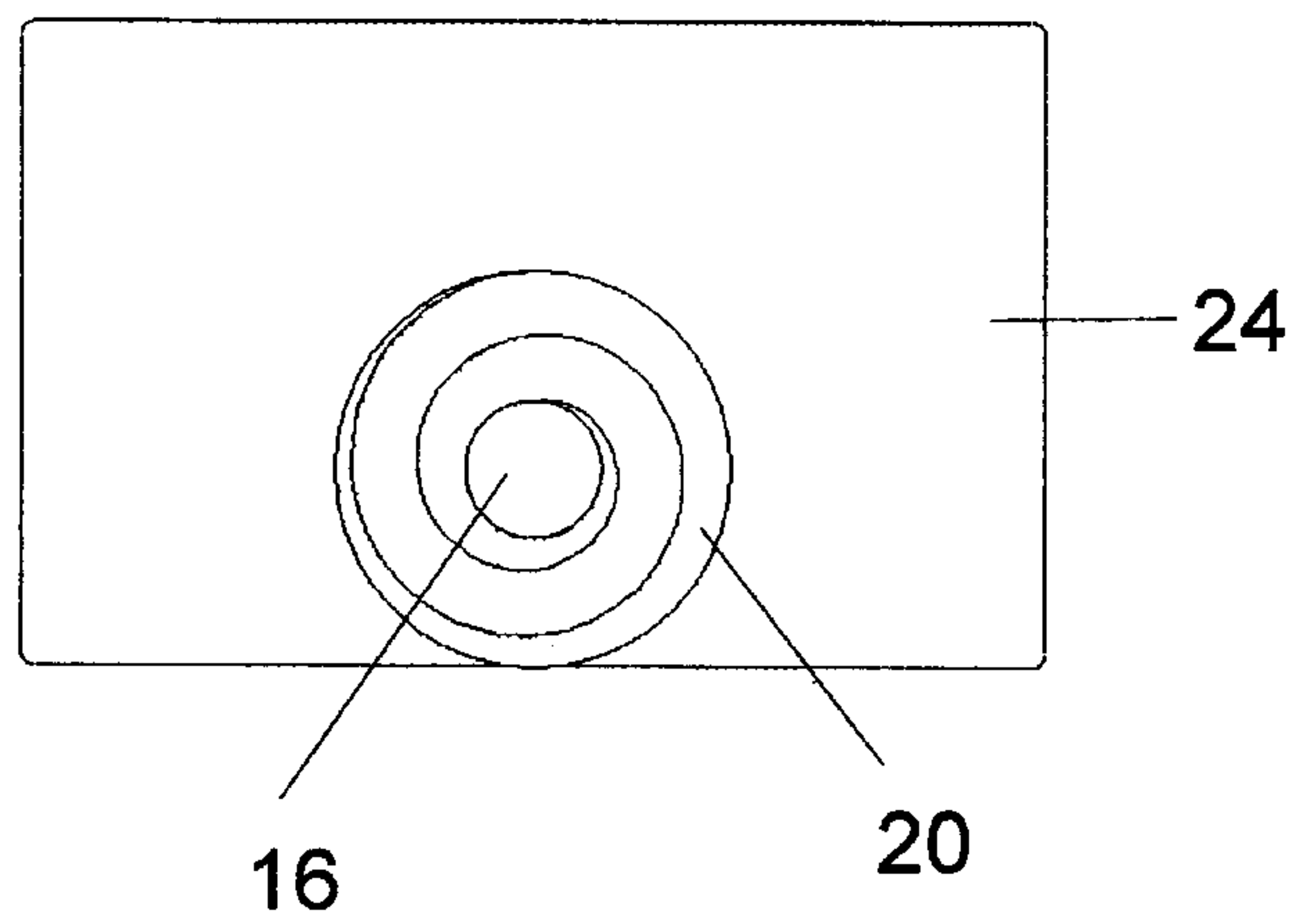
- 5       providing two pond covers, each pond cover having grommets positioned along a peripheral edge which define pond cover attachment openings; and
- providing apparatus for connecting the two pond covers, the apparatus comprising:
- a shaft having an exterior surface, a first end and a second end;
- an engagement profile positioned on the exterior surface at the first end of
- 10   the shaft; and
- a cable guide positioned in an intermediate position between the first end and the second end of the shaft, the cable guide being oriented transversely to the shaft, a cable being prevented from removal from the cable guide by the second end of the shaft;
- overlapping the peripheral edge of the two pond covers with the pond cover attachment
- 15   openings of the two pond covers axially aligned; and
- inserting the first end of the shaft of the apparatus into one of the pond cover attachment openings with the engagement profile preventing removal of the shaft from the pond cover attachment openings.
- 20   9. The method of Claim 8, the engagement profile being a helical thread, a rotational drive adaptor being positioned at the second end of the shaft and the step of inserting the first end of the shaft into one of the pond cover attachment openings being performed using a power drill.

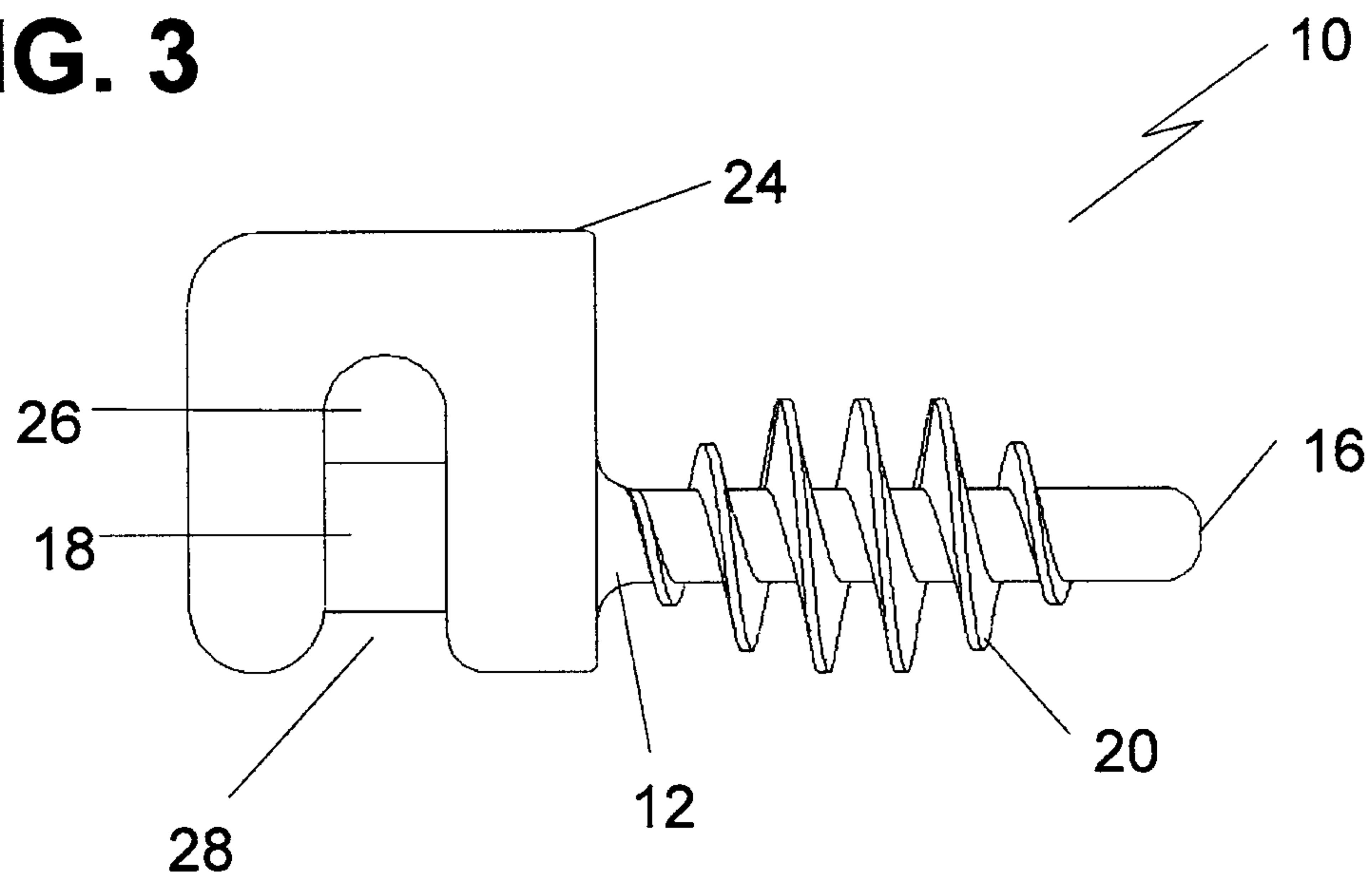
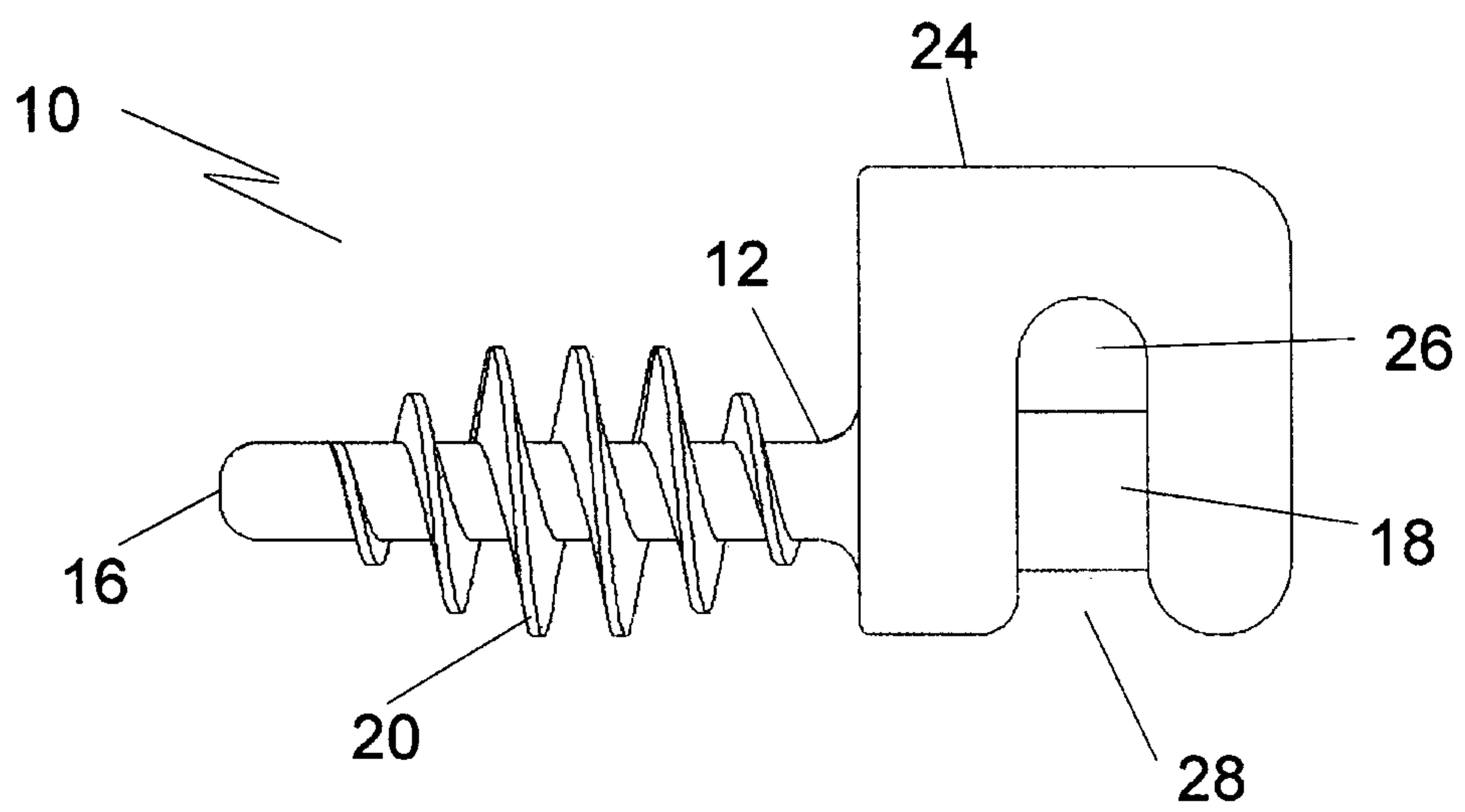


**FIG. 1**

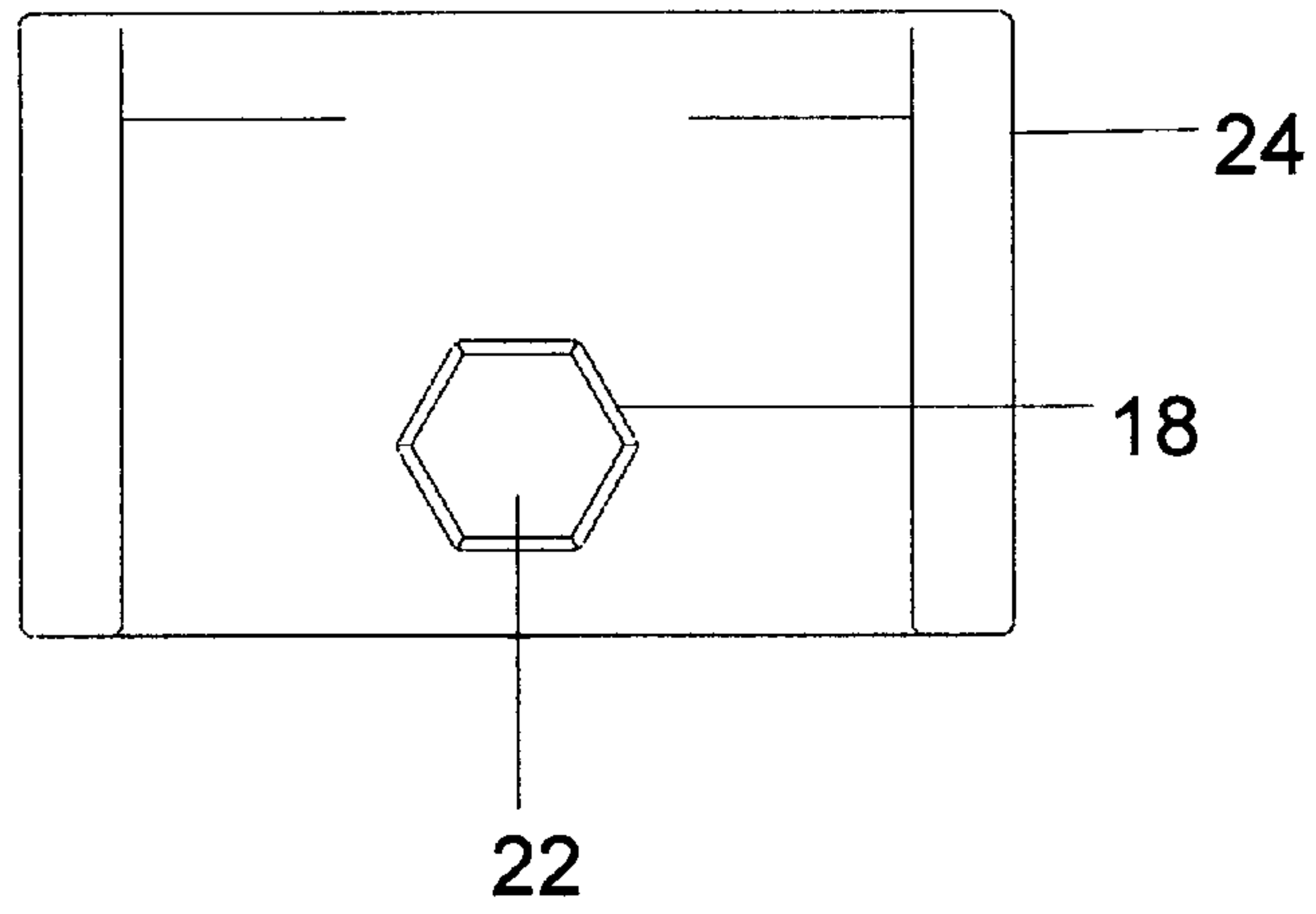


**FIG. 2**

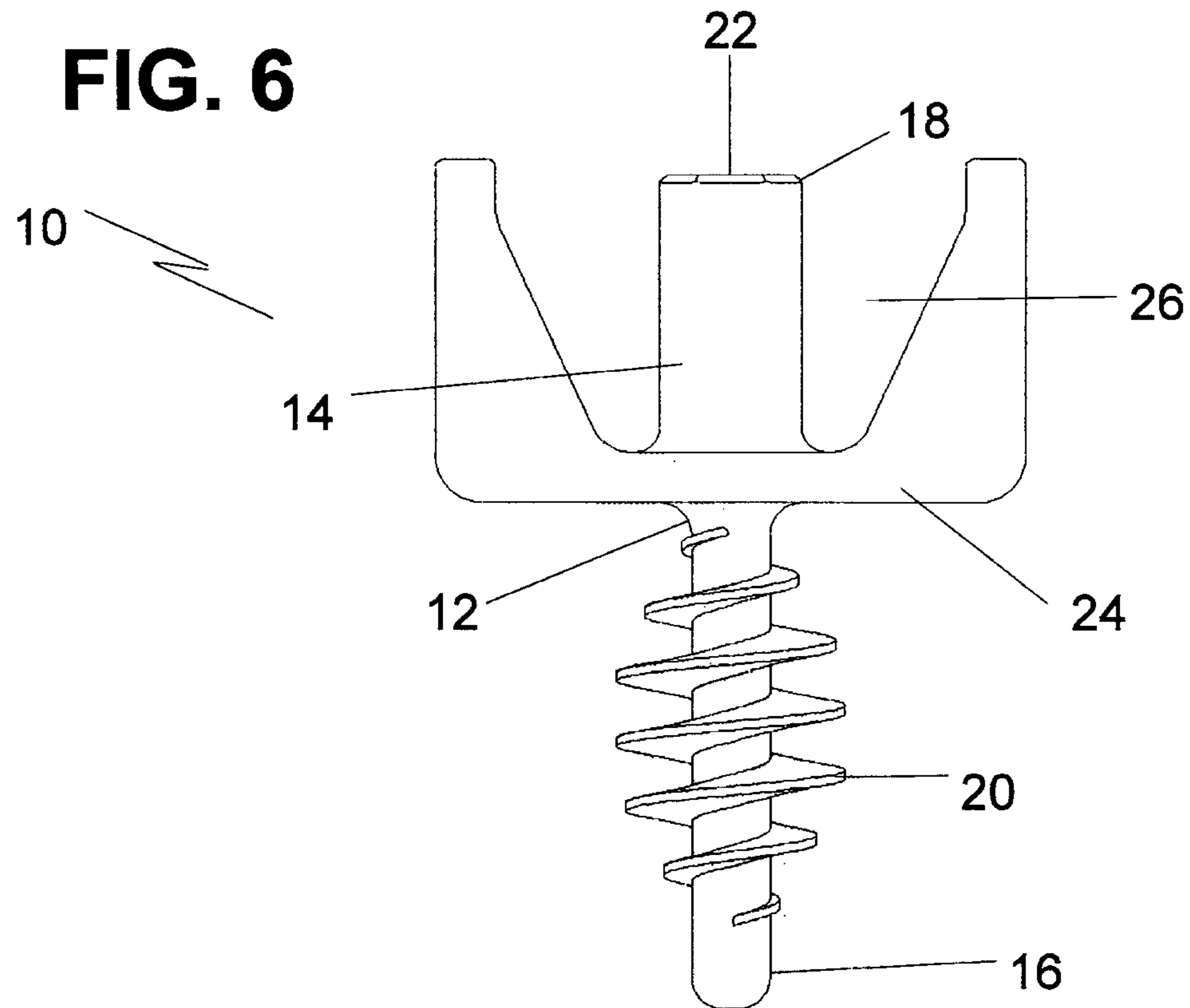


**FIG. 3****FIG. 4**

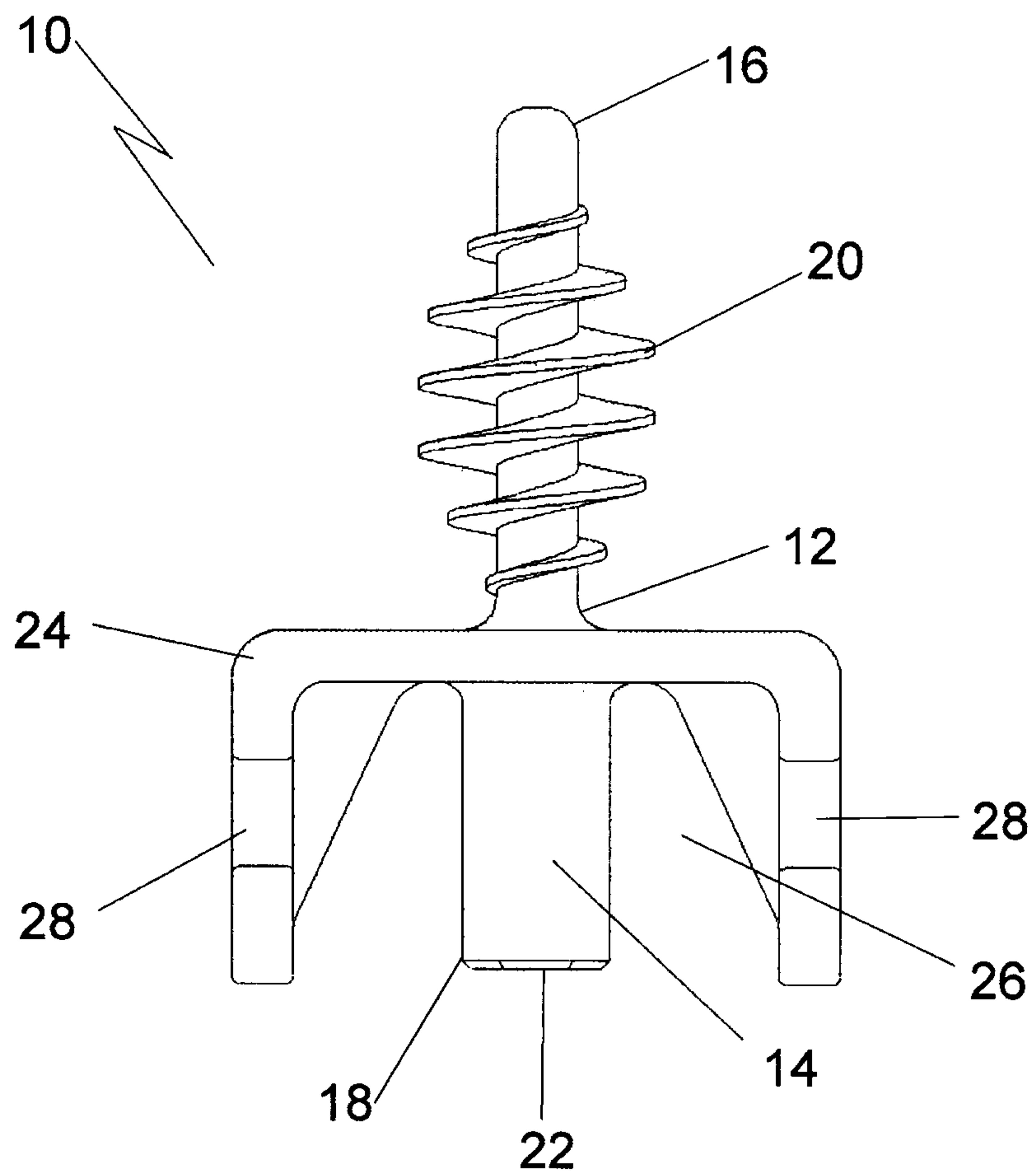
**FIG. 5**



**FIG. 6**





**FIG. 7**

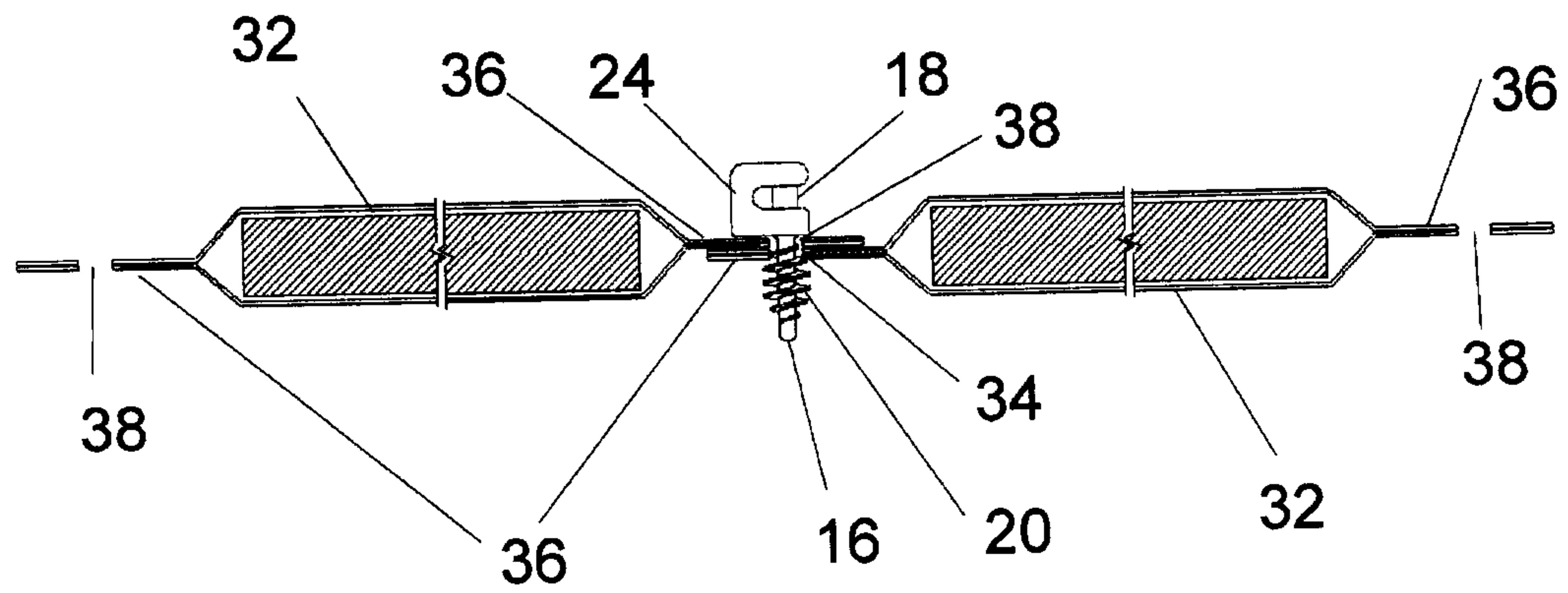
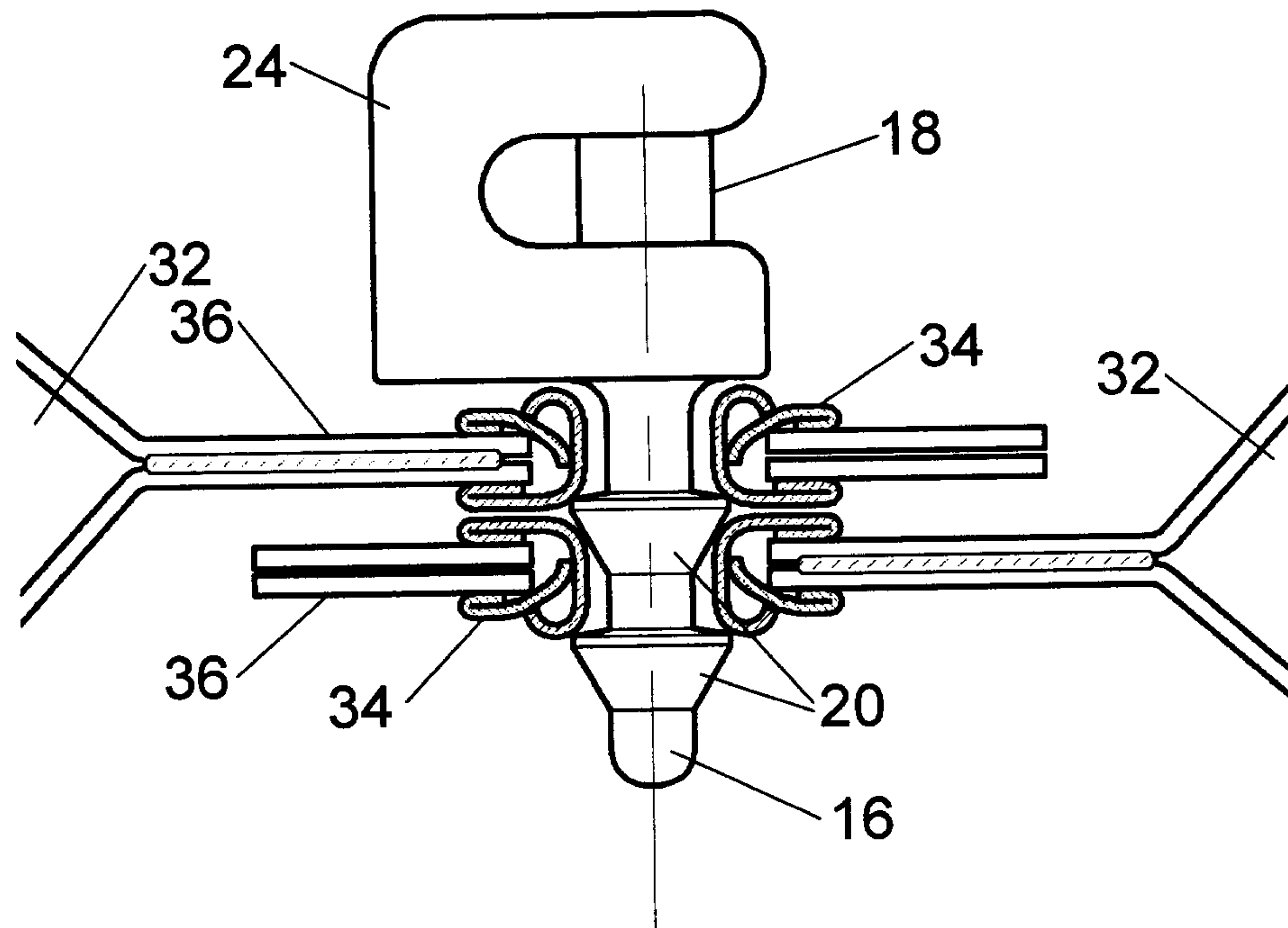
**FIG. 8****FIG. 9**

FIG. 10

